

Oval Strap Display Pool

Signature Series 10-1/2" Top Rails
 Classic 8-1/2" Top Rails
 Flare 7" Top Rails

Assembly/Installation Instructions

Assembling and installing this display pool on a solid surface (concrete, asphalt, tile, linoleum, etc.) is different than a typical ground installation. The horizontal support beams and pressure pads are buried in ground installations. For Display Pools, these components sit on top of the hard surface. Therefore, the pool wall and bottom frame is raised 1-1/2" above the floor surface. The pool floor must be elevated (using high density styrofoam) to match the level of the support beams and pressure pads as shown in Fig. A.

A shorter side vertical support beam is provided to accommodate this type of installation. On the Impressions Pool only, it will be necessary to cut off 1-1/2" from the top of the center sections of the side vertical panels and fencing strips as they will be lowered to meet the new floor level.

Refer to your Pool Assembly Guide and Pool Parts List for assembly and installation, modifying some procedures as outlined in these instructions.

Tension straps replace the concrete blocks used in ground installations.

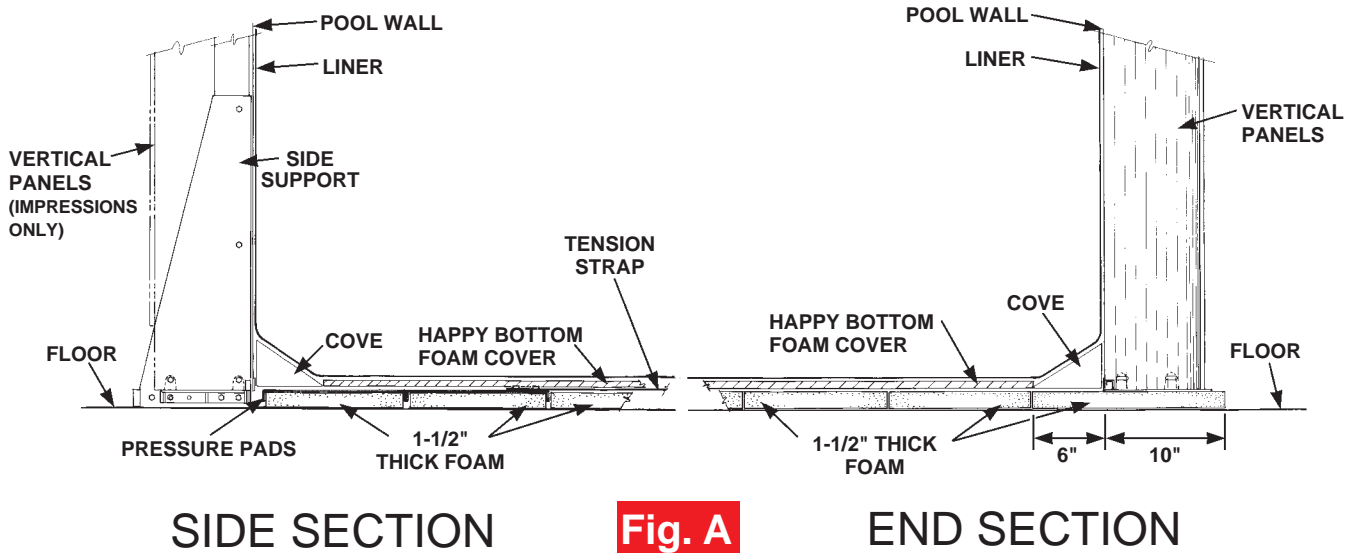

1 CUT TENSION STRAP

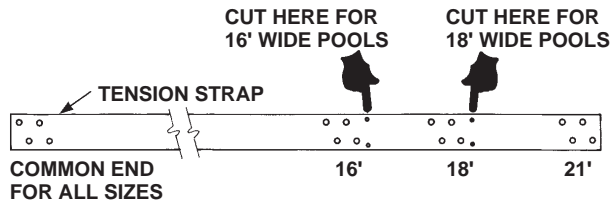

Determine the length of tension strap you will require. For 16' and 18' wide pools, you will need a hacksaw to cut off the extra strap before assembly. Cut through the two small holes just past the bolt holes indicated for your size pool. NOTE: For 12' wide pools there are separate straps that are used. Discard the type shown above and use the 12' straps.

2 SIDE SUPPORT ASSEMBLY (IMPRESSIONS)

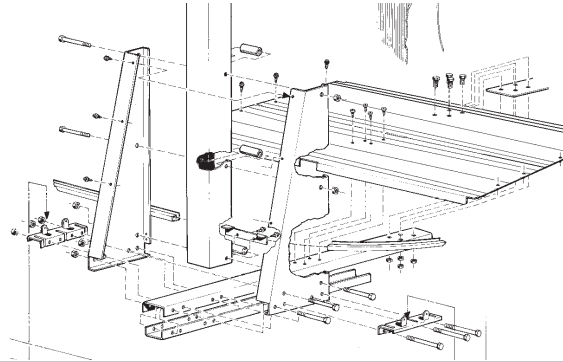

Referring to your Parts List, Pool Assembly Guide and the Parts Explosion on Page 4 of this booklet, assemble the side support as shown. NOTE: The side vertical bottom connector is secured at the bottom holes and the skid support is deleted. DO NOT assemble the bottom rail locator, outside pressure pad or tension straps at this time.

2A SIDE SUPPORT ASSEMBLY (CLASSIC 8-1/2")

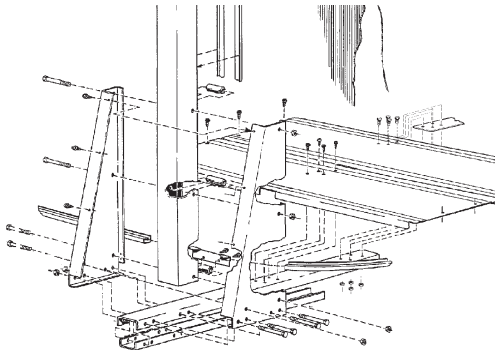

Referring to your Parts List, Pool Assembly Guide and the Parts Explosion on Page 5 of this booklet, assemble the side support as shown. NOTE: The skid support is deleted. DO NOT assemble the bottom rail locator, outside pressure pad or tension straps at this time.

2B SIDE SUPPORT ASSEMBLY (FLARE 7")

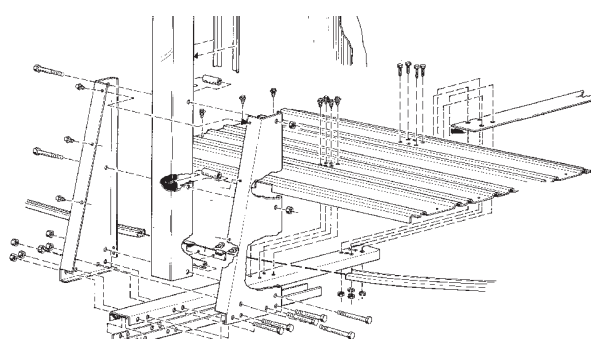

Referring to your Parts List, Pool Assembly Guide and the Parts Explosion on Page 6 of this booklet, assemble the side support as shown. NOTE: The skid support is deleted. DO NOT assemble the bottom rail locator, outside pressure pad or tension straps at this time.

3 SIDE SUPPORT INSTALLATION

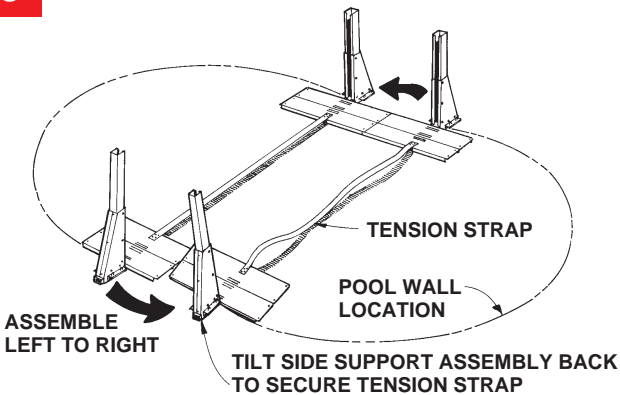

Position the side support assemblies at their installed locations. Place the outside pressure pad on the side support assembly and insert one end of the tension strap into the notch in the front lip of the pressure pad. Line up the four holes in the pressure pad, tension strap and upper ground support. Place four 1/4-20 bolts through the holes, tilt the side support assembly back and firmly secure the bolts with 1/4-20 nuts. Repeat this procedure for all side supports.

4 FOAM SUPPORTS

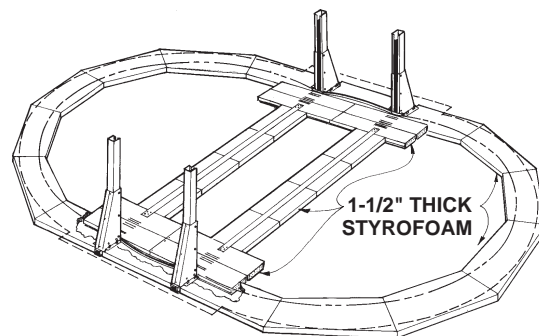

Check levelness and position of side support assemblies. Cut and position 1-1/2" thick high density styrofoam under pressure pads, tension straps and around the perimeter of the pool at the wall location. Foam should extend 10" outside wall and 6" inside wall. Multiple layers of plywood may be substituted (Total 1-1/2" thickness). Use duct tape to hold in position.

5 BOTTOM RAIL CONNECTORS

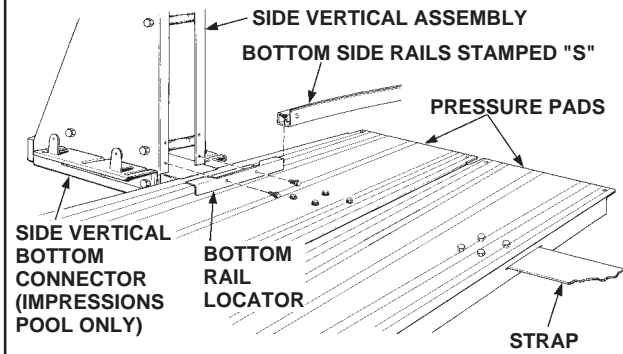

Assemble the bottom rail locators and bottom rails stamped "S" and attach them between the side verticals using the bottom two holes in the verticals.

6 FOAM BOTTOM

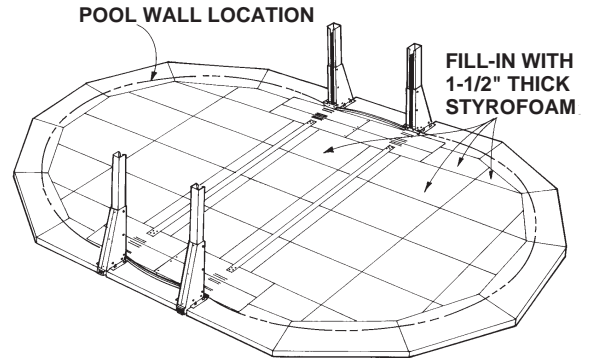

Fill in the remaining exposed areas inside the pool with 1-1/2" thick styrofoam or plywood. NOTE: The constructed base must form a solid, uninterrupted foundation under the entire pool. Fill-in even the smallest of openings in the foundation.

7 CUT VERTICAL (IMPRESSIONS ONLY)

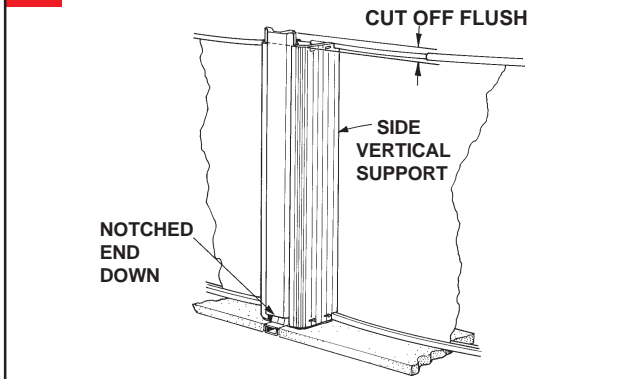

Install the wall and cove referring to your Pool Assembly Guide. When the three-piece side verticals are installed, the center section will extend up above the side panels approximately 1-1/2". Cut the center section flush with the top of the side panels.

8 FINAL ASSEMBLY

Finish the pool floor with a 1/2" thick layer of foam sheeting.

Referring to your Pool Assembly Guide, complete the pool structure, install the liner and fill the pool.

NOTE: During the final assembly and filling, check to make sure the foam pads do not shift to prevent depressions from appearing in the pool floor.

IMPRESSIONS

REMINDER:

Refer to your Pool Assembly Guide and Pool Parts List for assembly and installation, modifying some procedures as outlined in these instructions.

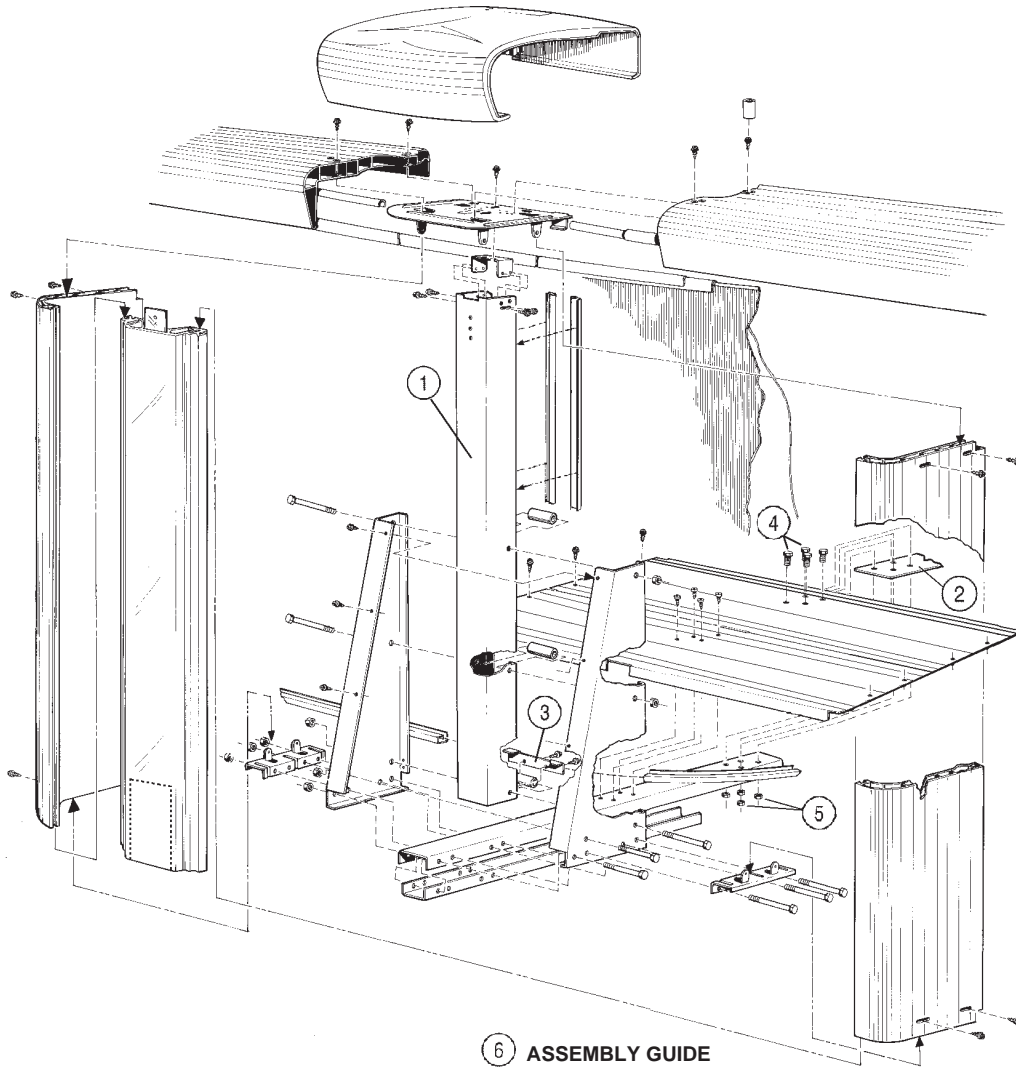

6 ASSEMBLY GUIDE

IMPRESSIONS STRAP DISPLAY PARTS LIST				
ITEM	P/N	DESCRIPTION	QTY - 4 PAK	QTY - 6 PAK
	0-8495-042	Strap Display Pack	1	-
	0-8495-043	Strap Display Pack	-	1
1	580-1868	Support Vertical	4	6
2	580-1790	Display Strap	2	3
3	580-1793	Bottom Rail Locator	4	6
4	510-1018	Bolt	16	24
5	511-1000	1/4-20 Nut	16	24
6	573-2885	Assembly Guide	1	1

CLASSIC 8-1/2 TOP RAIL

REMINDER:

Refer to your Pool Assembly Guide and Pool Parts List for assembly and installation, modifying some procedures as outlined in these instructions.

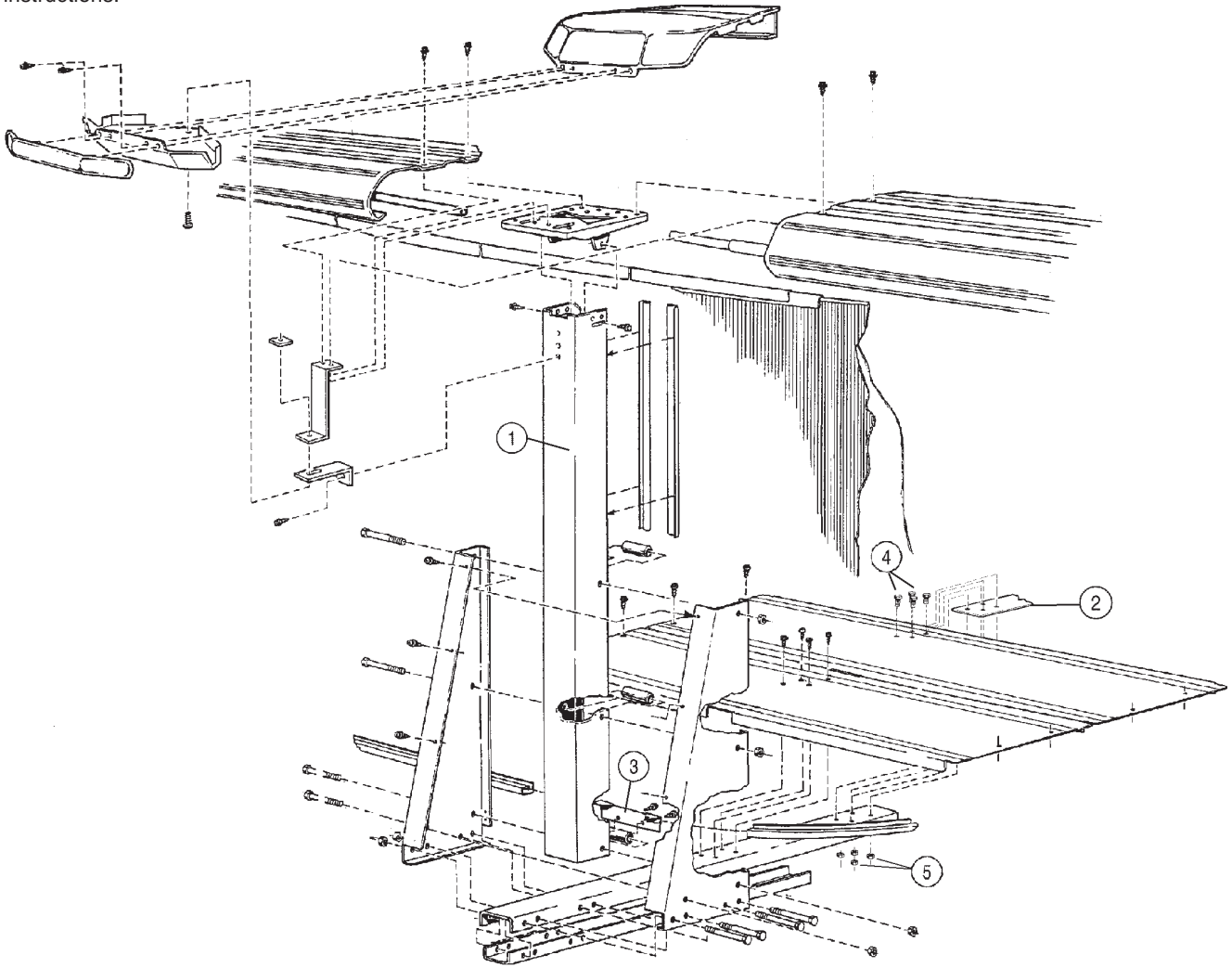

6 ASSEMBLY GUIDE

GRANITE RIDGE STRAP DISPLAY PARTS LIST				
ITEM	P/N	DESCRIPTION	QTY - 4 PAK	QTY - 6 PAK
	0-8495-042	Strap Display Pack	1	-
	0-8495-043	Strap Display Pack	-	1
1	580-1868	Support Vertical	4	6
2	580-1790	Display Strap	2	3
3	580-1793	Bottom Rail Locator	4	6
4	510-1018	Bolt	16	24
5	511-1000	1/4-20 Nut	16	24
6	573-2885	Assembly Guide	1	1

BLUE GLACIER STRAP DISPLAY PARTS LIST				
ITEM	P/N	DESCRIPTION	QTY - 4 PAK	QTY - 6 PAK
	0-8495-044	Strap Display Pack	1	-
	0-8495-046	Strap Display Pack	-	1
1	580-1867	Support Vertical	4	6
2	580-1790	Display Strap	2	3
3	580-1793	Bottom Rail Locator	4	6
4	510-1018	Bolt	16	24
5	511-1000	1/4-20 Nut	16	24
6	573-2885	Assembly Guide	1	1

FLARE 7" TOP RAIL

REMINDER:

Refer to your Pool Assembly Guide and Pool Parts List for assembly and installation, modifying some procedures as outlined in these instructions.

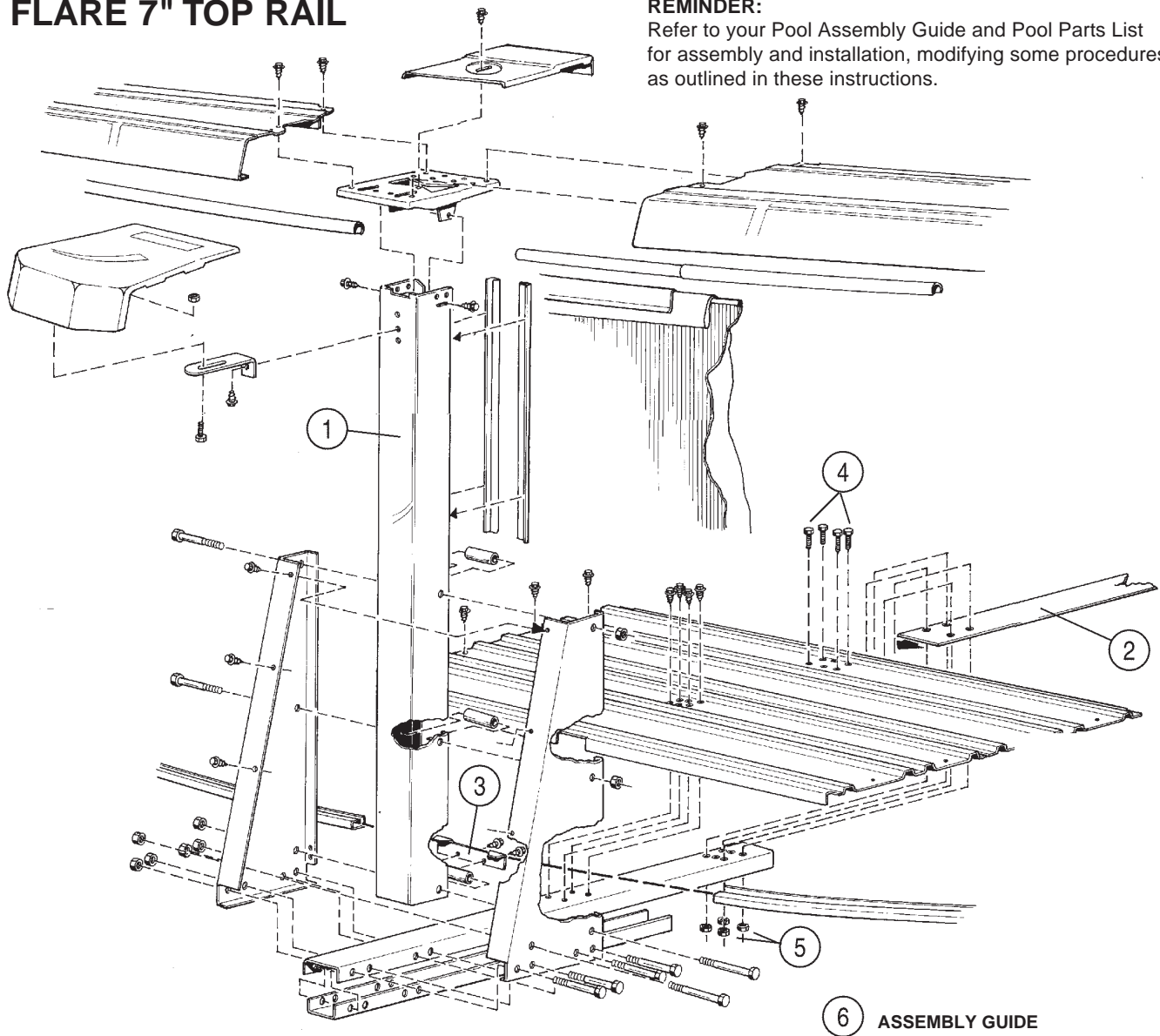

6 ASSEMBLY GUIDE

SMOKY POINTE II STRAP DISPLAY PARTS LIST				
ITEM	P/N	DESCRIPTION	QTY - 4 PAK	QTY - 6 PAK
	0-8495-042	Strap Display Pack	1	-
	0-8495-043	Strap Display Pack	-	1
1	580-1868	Support Vertical	4	6
2	580-1790	Display Strap	2	3
3	580-1793	Bottom Rail Locator	4	6
4	510-1018	Bolt	16	24
5	511-1000	1/4-20 Nut	16	24
6	573-2822	Assembly Guide	1	1

ADOBE CANYON II STRAP DISPLAY PARTS LIST				
ITEM	P/N	DESCRIPTION	QTY - 4 PAK	QTY - 6 PAK
	0-8495-034	Strap Display Pack	1	-
	0-8495-036	Strap Display Pack	-	1
1	580-1896	Support Vertical	4	6
2	580-1790	Display Strap	2	3
3	580-1793	Bottom Rail Locator	4	6
4	510-1018	Bolt	16	24
5	511-1000	1/4-20 Nut	16	24
6	573-2822	Assembly Guide	1	1

"the original portable pool"



DOUGHBOY RECREATIONAL • 10959 JERSEY BLVD. • RANCHO CUCAMONGA, CA 91730

DB 896-047

Made in the United States of America

Copyright © 1996