



Return Fitting Set

Models 1121-1300 (Gray) / 1121-1460 (White) /
1121-1461 (Almond)

Owner's Guide

RETURN FITTING INSTALLATION

To Replace Existing Lomart Return Fitting: Drain the pool down about 1" below the return fitting. Completely remove the return fitting from the wall. Follow "Installation" below.

To Replace Existing Return Fitting Other Than Lomart: The hole through the wall must be a minimum of 1-15/16" in diameter and cannot exceed 2-1/8" in diameter. Drain the pool down about 1" below the return fitting. Completely remove the return fitting from the wall. Follow "Installation" below.

For a New Pool Installation: Locate a board large enough to cover return fitting cutout. From inside of pool, use the board to hold liner against cutout in pool wall. Keep hands away from hole to avoid injury. From outside of pool, use the cutout as a guide and cut away liner with a razor knife.

Installation:

- Slip a gasket (2) over the threads of the return fitting adaptor (3), and push threaded end through the wall from inside pool. Place the second gasket over the threads now exposed outside the pool.
- Hold the return fitting body (1) so the hose fitting end points straight up while turning the adaptor from inside the pool. When the adaptor just begins to crush the gaskets, hold the adaptor from turning while rotating the body clockwise to its straight down position.
- If the assembly does not feel snug, rotate the return fitting body back to the up position. Rotate the adaptor inside pool an additional 1/4 turn, then rotate the body to the down position again. Repeat this procedure as required.
- Your Return Fitting Kit comes with two eyeballs. One has a smaller opening than the other. Some filter systems will require the smaller opening for proper operation. To determine which eyeball to use, start with the larger opening. If your pump develops a noise sounding like marbles are inside, your system requires more back pressure. The eyeball with the smaller opening should be used.
- Install eyeball insert (5) into eyeball (6). Hold the eyeball inside the adaptor (3) with insert toward inside. Thread on the return fitting cover (7) to secure eyeball position so it directs flow away from skimmer opening. Do not overtighten.
- Reconnect return hose after installation has been completed. Fill your pool to midway between the two water level markers on the faceplate of your skimmer. Inspect installation for leaks.

NOTE: The shut-off disc (4) is supplied to provide an easy way to block water flow from the return fitting. Use it when you need to service the filter system, or for winterizing the return fitting. To winterize, unscrew the return fitting cover (7) and remove the eyeball (6). Insert the disc in place of the eyeball and reinstall the cover.

CAUTION: Failure to keep return fitting tight can cause leakage between return fitting and pool wall. Continued leakage may cause wall damage which eventually may result in pool wall failure.

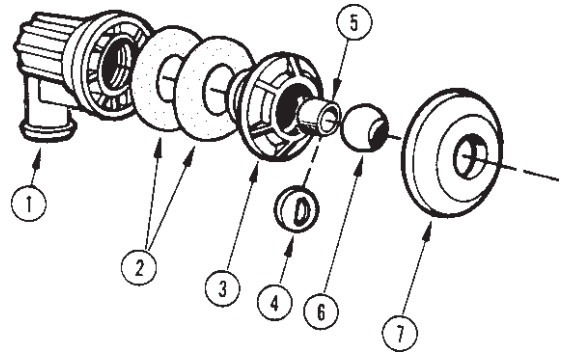

MODEL 1121-1300 PARTS LIST

ITEM	P/N	QTY	DESCRIPTION
1	340-1591	1	Return Fitting Body
2	308-1110	2	Return Fitting Gasket
3	340-1592	1	Return Fitting Adaptor
4	340-1594	1	Shut-Off Disc
5	340-1595	1	Eyeball Insert
6	348-1030	1	Eyeball w/Flow Control
	348-1027	1	Eyeball
7	340-1593	1	Return Fitting Cover
8	365-1687	1	Owner's Guide

MODEL 1121-1460 PARTS LIST

ITEM	P/N	QTY	DESCRIPTION
1	340-1793	1	Return Fitting Body
2	308-1110	2	Return Fitting Gasket
3	340-1791	1	Return Fitting Adaptor
4	340-1792	1	Shut-Off Disc
5	340-1801	1	Eyeball Insert
6	348-1030	1	Eyeball w/Flow Control
	348-1027	1	Eyeball
7	340-1790	1	Return Fitting Cover
8	365-1687	1	Owner's Guide

MODEL 1121-1461 PARTS LIST

ITEM	P/N	QTY	DESCRIPTION
1	340-1773	1	Return Fitting Body
2	308-1110	2	Return Fitting Gasket
3	340-1237	1	Return Fitting Adaptor
4	340-1240	1	Shut-Off Disc
5	340-1278	1	Eyeball Insert
6	348-1030	1	Eyeball w/Flow Control
	348-1027	1	Eyeball
7	340-1238	1	Return Fitting Cover
8	365-1687	1	Owner's Guide

Change of Design: Lomart Industries expressly reserves the right to change or modify the design and construction of any product in due course of our manufacturing procedures, without incurring any obligation or liability to furnish or install such changes or modifications on products previously or subsequently sold.



LOMART INDUSTRIES
10959 JERSEY BLVD.
RANCHO CUCAMONGA, CA 91730-5194